

**Pembrokeshire County Council
Cyngor Sir Penfro**



DOG BYLAWS FOR BEACHES AND PROMENADES

BYELAWS FOR BEACHES AND PROMENADES

Byelaws made by the County Council of PEMBROKESHIRE under Sections 82 and 83 Of the Public Health Acts Amendment Act 1907 and Section 235 of the Local Government Act 1972 with respect to the seashore and the promenades.

EXTENT

I. (1) Byelaws 3 and 4 apply to the beach, being an area of the seashore described in Schedule I hereinafter referred to as "the dog prohibited beach" and to any slope or staircase leading on to any beach.

(2) Byelaw 5 applies to all the promenades described under section 27 of the Road Traffic Act 1988. Promenades to which Byelaw 5 applies shall hereinafter referred to as "the promenades".

(3) Byelaws 5 does not apply in respect of any dog to which section I of the Dangerous Dogs Act 1991 applies.

(4) Notice of the effect of these byelaws shall be given signs placed in conspicuous positions on the approaches to the dog prohibited beach and the promenades.

INTERPRETATION

2. In these byelaws;

(1) "the Council" means the PEMBROKESHIRE COUNTY COUNCIL.

(2) For the purposes of these byelaws the keeper of the dog shall be deemed in charge thereof, unless the dog had been placed in or taken into the charge of some other person at the time when an offence under these byelaws had been committed.

(3) In paragraph (2) above "the keeper" shall include the owner of the dog or any person who habitually has it in his possession.

DOGS ON THE BEACH

3. Between 1 May and 30 September inclusive in any year, every person (other than a registered blind person) in charge of a dog who without reasonable excuse permits the dog to enter or remain on the dog prohibited beach shall be guilty of an offence.

4. An officer of the Council or any constable may require a person in charge of a dog which has entered the dog prohibited beach to remove the dog therefrom.

DOGS ON LEADS

5. Between 1st May and 30th September inclusive in any year no person in charge of a dog shall without reasonable excuse, permit the dog to enter or remain on any of the promenades unless the dog is held on a lead and is restrained from behaviour giving reasonable grounds for annoyance.

PENALTY

6. Any person offending against byelaw 3 or 5 shall be liable on summary conviction to a fine not exceeding level 2 on the standard scale.

SAVING OF CROWN AND OTHER RIGHTS

7. Nothing contained in any of the foregoing byelaws shall be deemed to be or shall operate as a grant by or on behalf of the Crown as owner of any part of the foreshore and seabed below high water mark or of any estate or interest in or right over any part of the foreshore and seabed, nor shall anything contained in or done under any of the provisions of the foregoing byelaws in any respect prejudice or injuriously affect any rights and interests of the Crown in

such foreshore and seabed or prevent the exercise thereon of any public rights or prejudice or injuriously affect any right, power or privilege legally exercisable by any person in, over and in respect of the foreshore and seabed.

SCHEDULE 1

"The dog prohibited beach" referred to in byelaw 1(1) is the area hatched blue on the plan annexed to these byelaws.

SCHEDULE 2

"The promenades" referred to in byelaws 1(2) and 1(3) is the area shaded yellow on the plan annexed to these byelaws.

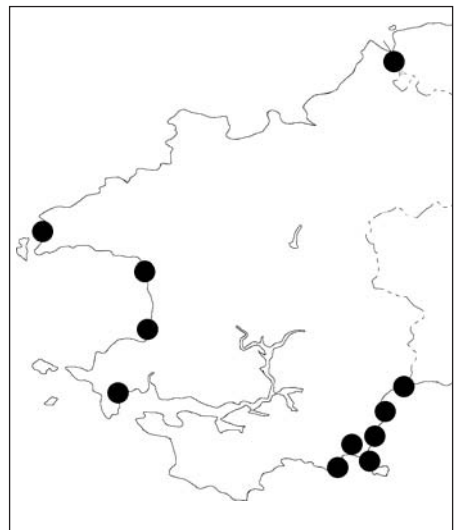

Lydstep Beach

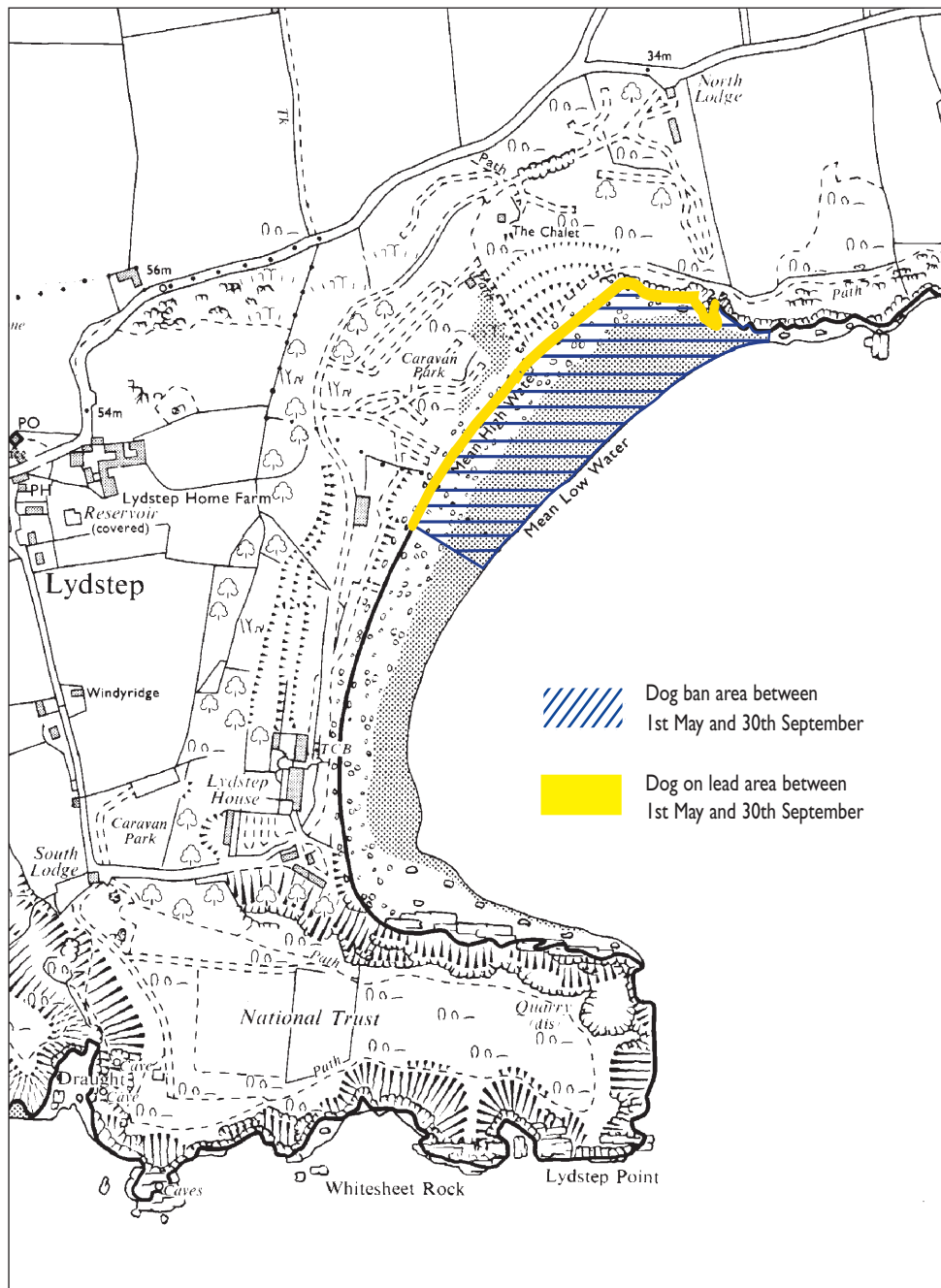

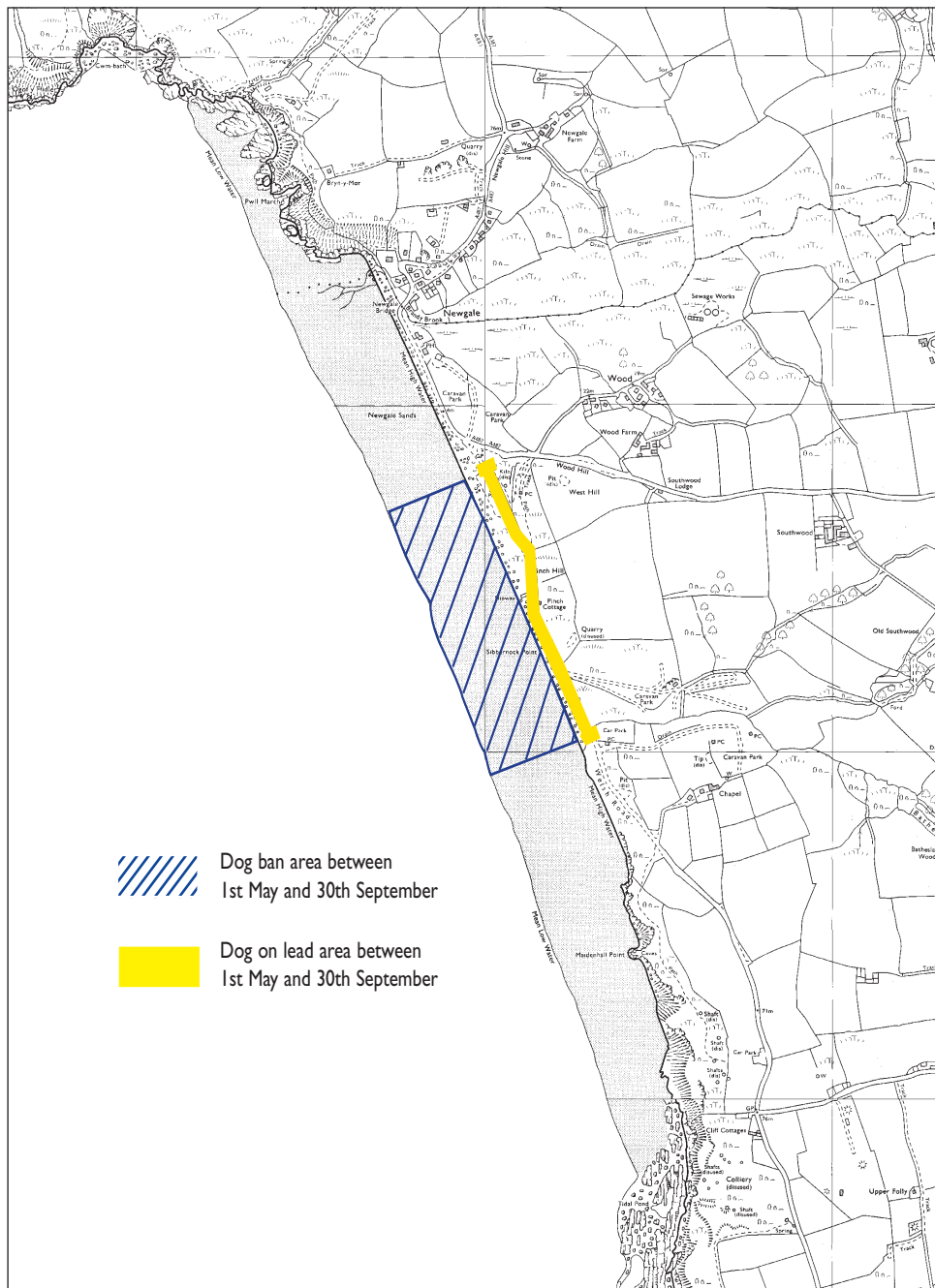

3 Saundersfoot Beach and Promenade

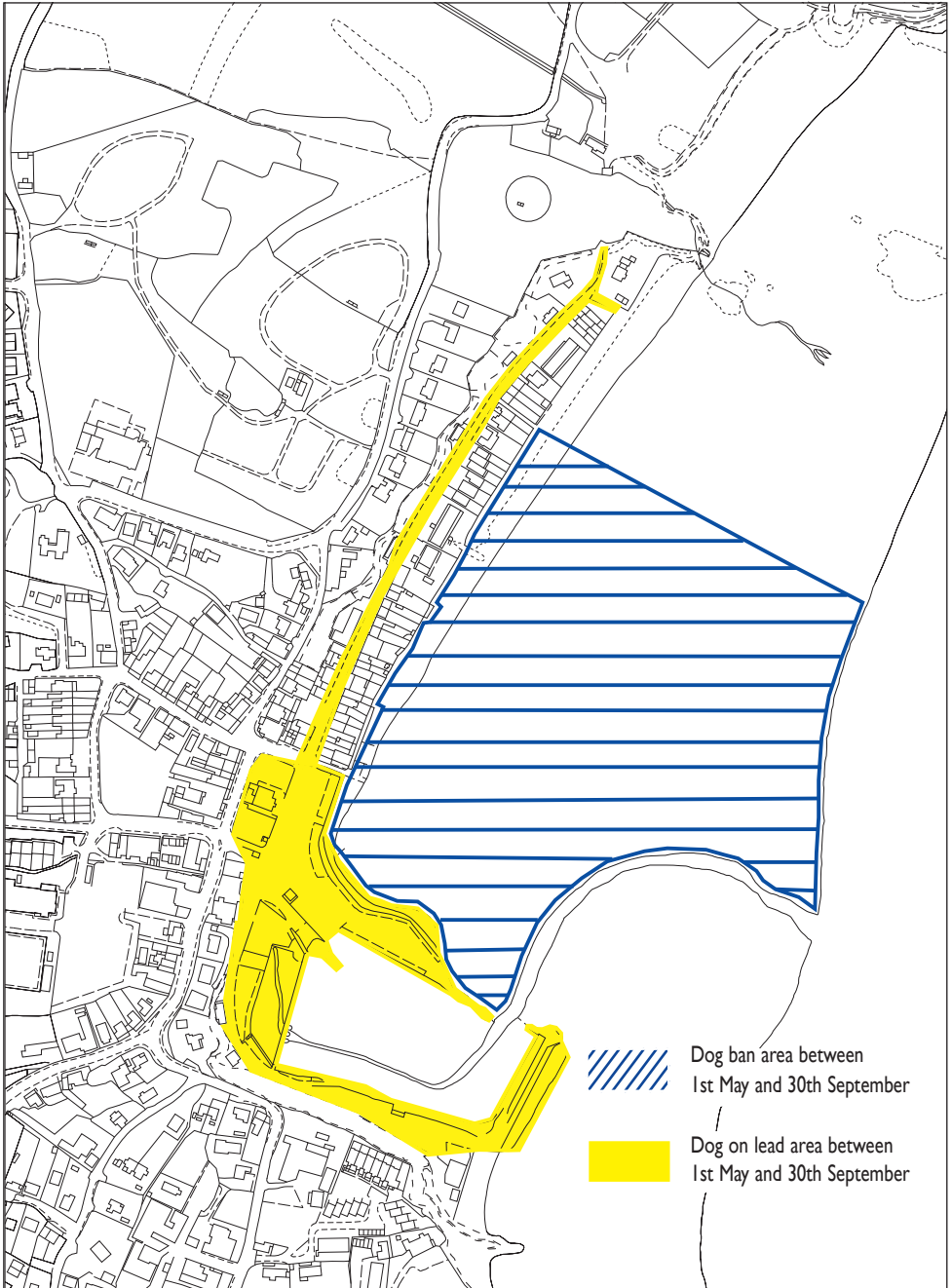

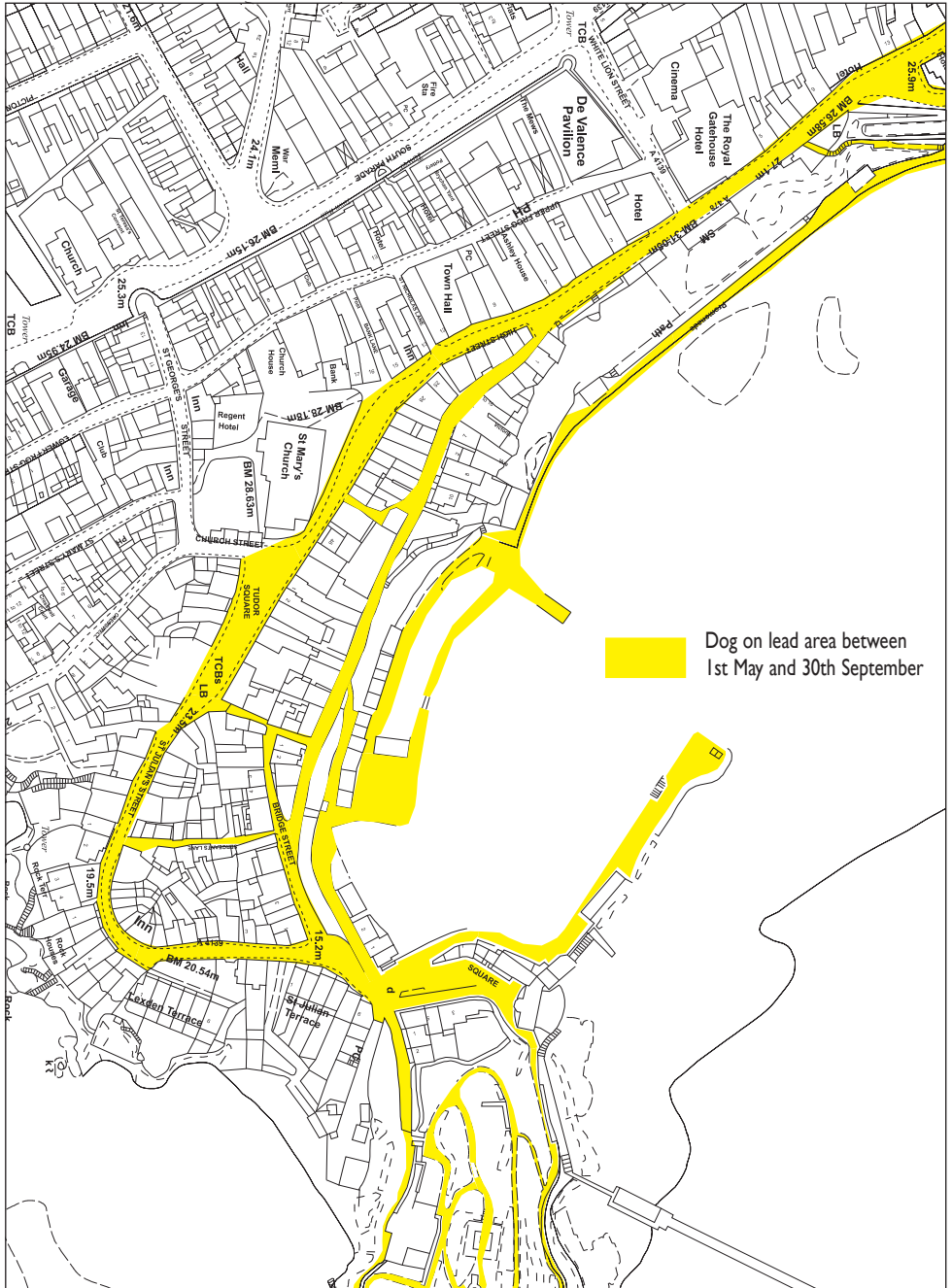

5 Tenby Castle & South Beach

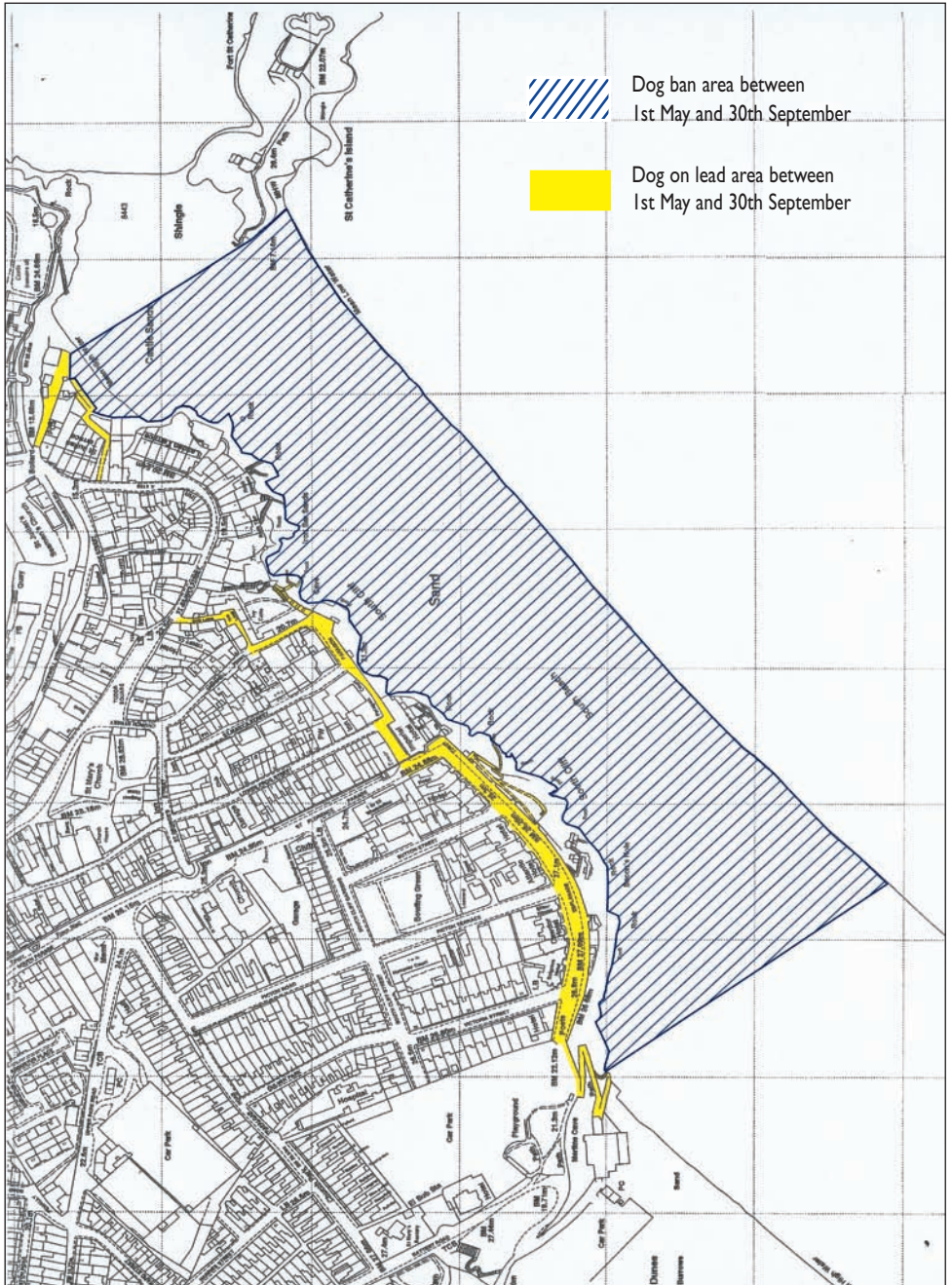

6 Tenby North Beach & Harbour Beach

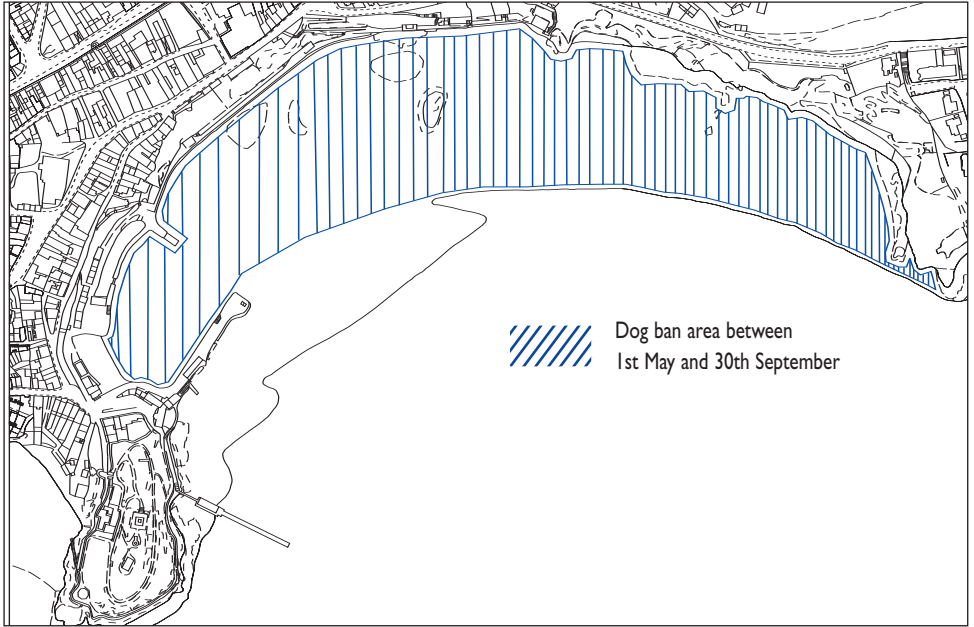

7 Amroth Beach and Promenade

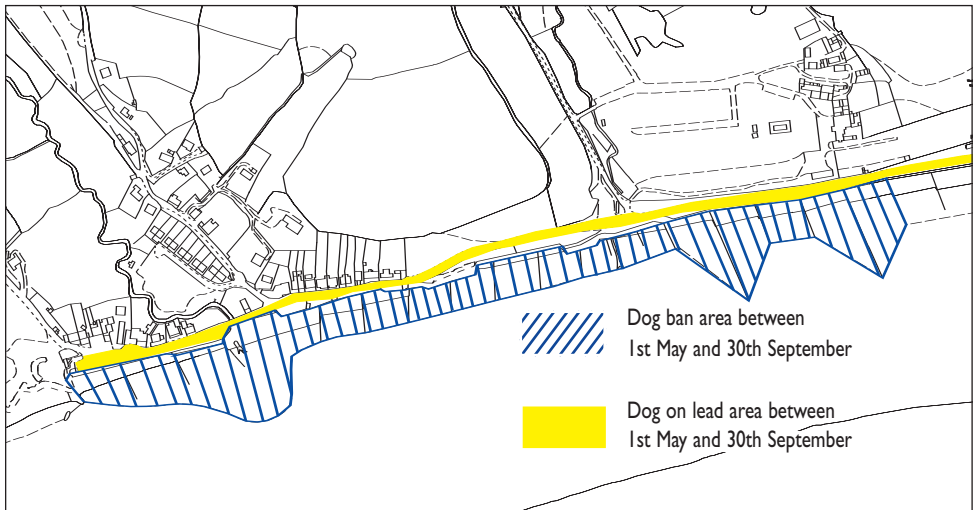

8 Whitesands

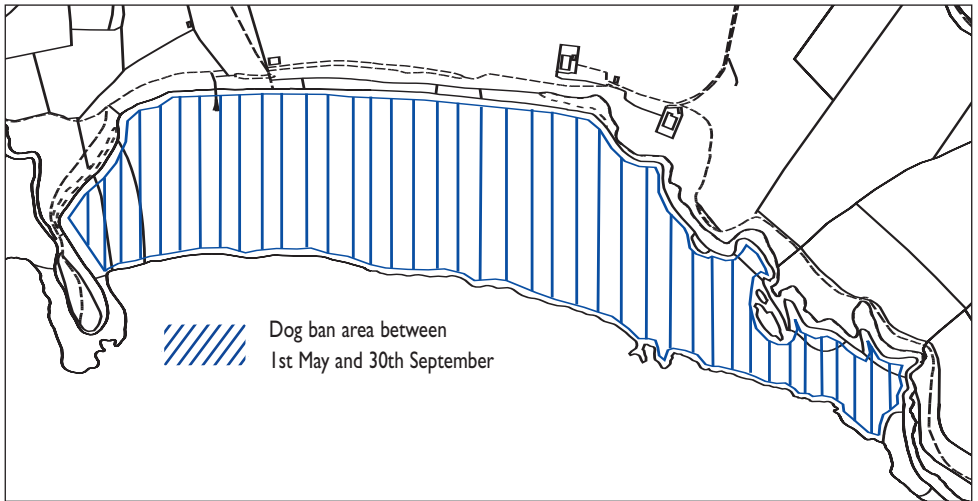

9 Poppit Sands

